

SEAFLO 4" 235CFM In-Line Bilge Blower Fan

In-Line Bilge Blower Fan 4" 235CFM

Designed for efficient, high output operation, these blowers feature our exclusive front and rear shaft seals and corrosion resistant motor housings for long life. Compact and easily installed on any flat surface, SEAFLO in-line blowers provide higher air flow, lower amp draw, and quieter operation than standard blowers.

FEATURES & BENEFITS



MORE FEATURES & BENEFITS

- Meets or exceeds ISO8846 certification.
- Built-in mounting feet allows easy vertical or horizontal installation.
- Very low current draw, high volum air flow, long life.
- Five blade fan maximizes airflow and efficiency .
- Sealed motor shaft for moisture protection.
- Corrosion resistant ABS plastic housing.
- Smaller size for any limited area.

DIMENSIONS

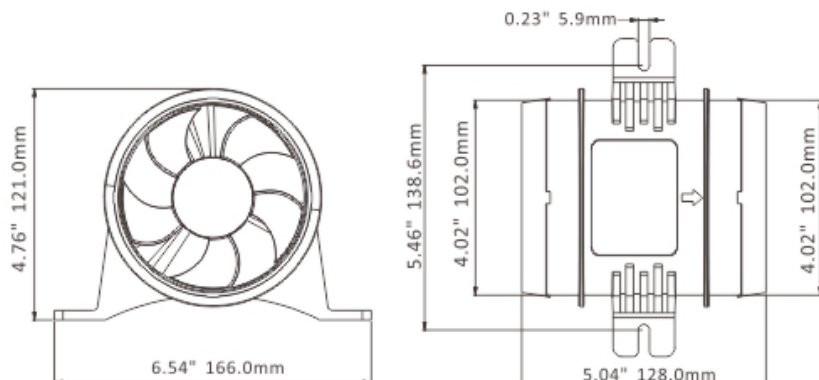

APPLICATION

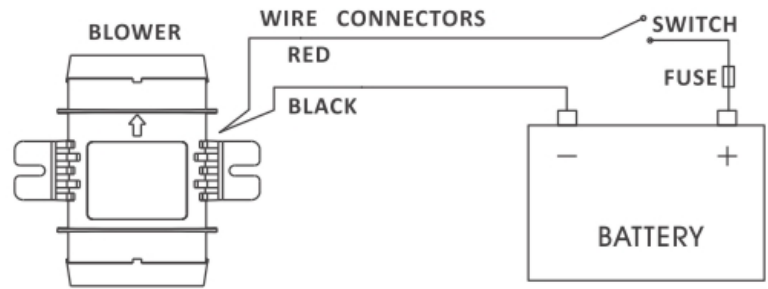

STANDARD PUMP CONFIGURATIONS

Model	Voltage	Air Flow (cfm/cmh)	Max Draw (A)	Fuse (A)	Intake Pipe Dia	Packing Size(mm)
SFIB1-235-04	12V	235/400	4.0A	7.0A	4"/102 mm	170*133*123
SFIB2-235-04	24V	235/400	2.0A	4.0A	4"/102 mm	170*133*123

DETAILED COMPOSITION

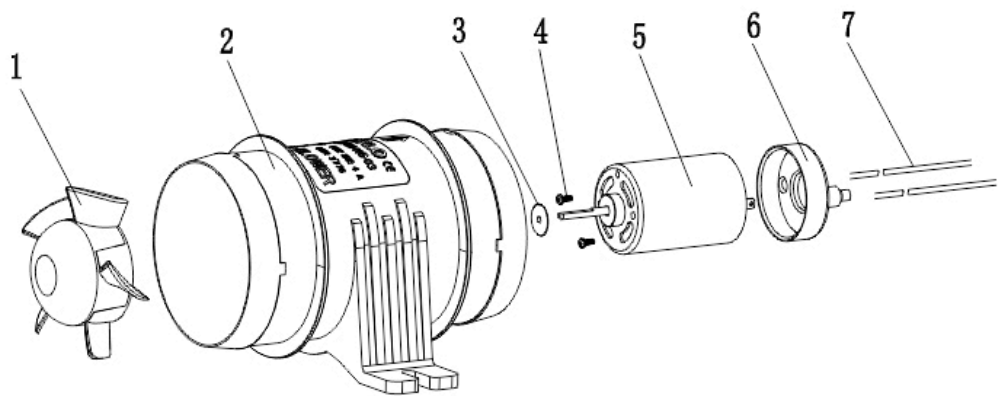

Key	Description	Quantity
1	Impeller	1
2	Housing	1
3	Gasket	3
4	Screw	1
5	Motor	1
6	Motor Cover	1
7	Power Cabler	3