

SEAFLO 4" 270CFM In-Line Bilge Blower Fan

SEAFLO 4" In-line Blowers provide ventilation for bilges, engine compartments, galleys and heads. Designed for efficient, high output operation, these blowers feature our exclusive front and rear shaft seals and corrosion resistant motor housings for long life. Compact and easily installed on any flat surface, SEAFLO In-line Blowers provide higher air flow and lower amp draw.

FEATURES & BENEFITS

Very low current draw, high volume air flow, long life

Six-blade fan maximizes airflow and efficiency

Built-in mounting feet allow easy vertical or horizontal installation

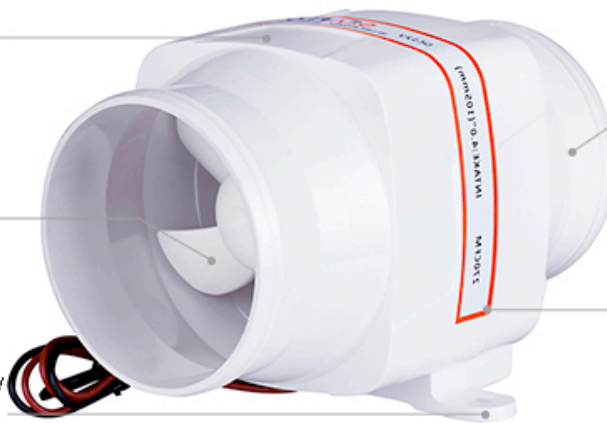

Sealed motor shaft for moisture protection

Corrosion resistant ABS plastic housing

MORE FEATURES & BENEFITS

- Meets or exceeds ISO8846 certification.
- Built-in mounting feet allows easy vertical or horizontal installation.
- Very low current draw, high volum air flow, long life.
- Four-blade fan maximizes airflow and efficiency.
- Sealed motor shaft for moisture protection.
- Corrosion resistant ABS plastic housing.

DIMENSIONS

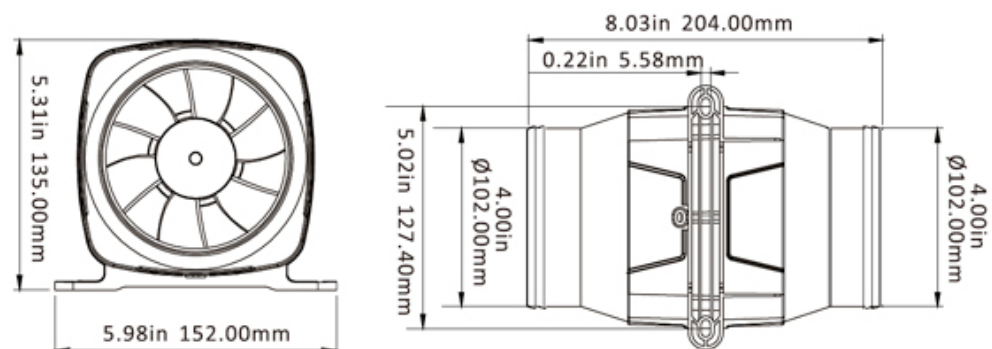

270 CFM

APPLICATION

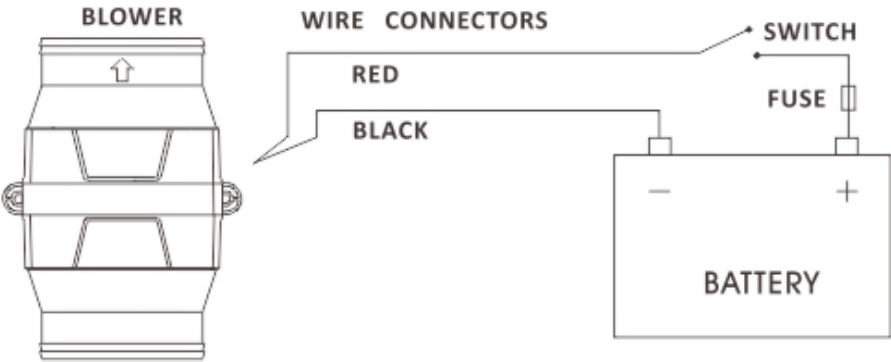

STANDARD PUMP CONFIGURATIONS

Model	Voltage	Air Flow (cfm/cmh)	Max Draw (A)	Fuse (A)	Intake Pipe Dia	Packing Size(mm)	N.W./G.W. (kg)
SFIB1-270-02	12V	270/456	6.0A	10.0A	4"/102	207*154*114	0.70/0.90 kg
SFIB2-270-02	24V	270/456	3.0A	5.0A	4"/102	207*154*114	0.70/0.90 kg

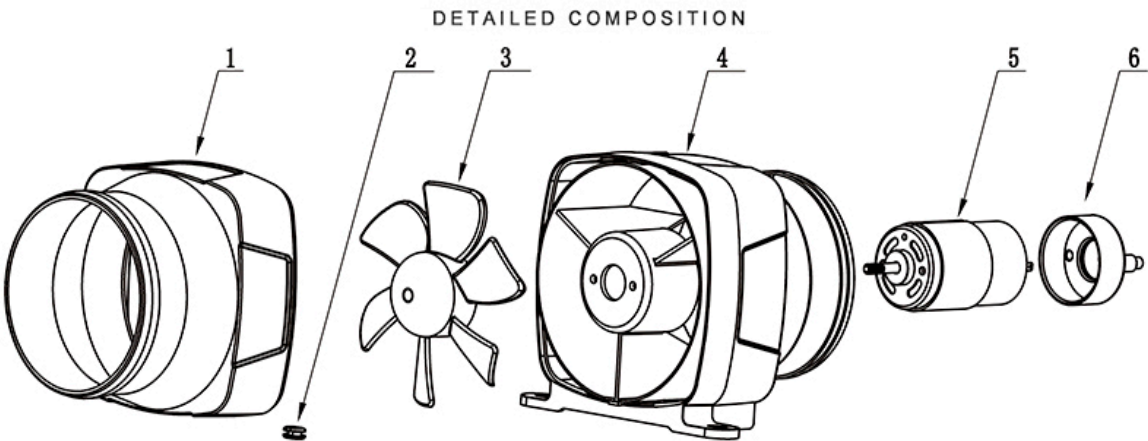

Key	Description	Quantity
1	Upper Housing	1
2	Impeller	1
3	Wire Buckle	3
4	Bottom Housing	1
5	Motor	1
6	Motor Cover	3